



Ø30 PUSHBUTTON SWITCH

KH-30XX Series



CLASSIFICATION

KH-30XX - 1 1 R

① ②③④

| | | |
|-----------|----------------------|---|
| ① SHAPE | 08 | PROTECTIVE GUARD |
| | 81 | PUSHBUTTON |
| | 81EB | MUSHROOM HEAD |
| | 40 | Ø40 HEADPUSHBUTTON |
| | 46ER | MUSHROOM HEAD/MAINTAINED/TURN TO RETURN |
| | 65EB | Ø75 HEAD PUSHBUTTON |
| | 66EB | Ø75 HEAD PUSHBUTTON/PROTECTIVE RING |
| ② CONTACT | NUMBER OF NO CONTACT | |
| | NUMBER OF NC CONTACT | |
| ④ COLOR | R | RED |
| | G | GREEN |
| | Y | YELLOW |
| | BK | BLACK |



KH-3008



- Protective guard for avoiding mal-operation
- Momentary action
- Materials
 - Body: Nylon glass
 - Contact housing: Nylon glass
 - Ring: ABS (chrome plated)

KH-3081, -3081EB



- Momentary action
- Materials
 - Body: Phenol
 - Contact housing: Nylon glass
 - Ring: ABS (chrome plated)

KH-3040



- Protective guard for avoiding mal-operation
- Momentary action
- Ø40 big head
- Materials
 - Body: Phenol
 - Contact housing: Nylon glass
 - Ring: Aluminum die-casting (chrome plated)

CONTROL COMPONENTS

SQUARE LIGHT

TOWER LIGHT

MICRO SWITCH

FOOT SWITCH

LIMIT SWITCH

POWER SWITCH

HOIST SWITCH

CAM SWITCH

BUZZER

PHOTO SENSOR

PROXIMITY SENSOR

FLOATLESS LEVEL SWITCH

TIMER & COUNTER

RELAY

SOCKETS

TERMINAL BLOCK

CONTROL BOX

PID TEMP. CONTROLLER



KH-3046ER



- Body is made of Zinc alloy die-casting
- Maintained action (turn to reset)
- Materials
 - Body: Zinc alloy die-casting
 - Contact housing: Nylon glass
 - Ring: Aluminum

KH-3065EB



- Ø75 big head
- Momentary action
- Materials
 - Body: Zinc alloy die-casting
 - Contact housing: Nylon glass
 - Ring: Zinc alloy die-casting (chrome plated)
 - Button: Phenol

KH-3066EB



- Ø75 big head
- Protective guard for avoiding mal-operation
- Momentary action
- Materials
 - Body: Zinc alloy die-casting
 - Contact housing: Nylon glass
 - Ring: Zinc alloy die-casting (chrome plated)
 - Button: Phenol



KH-3008

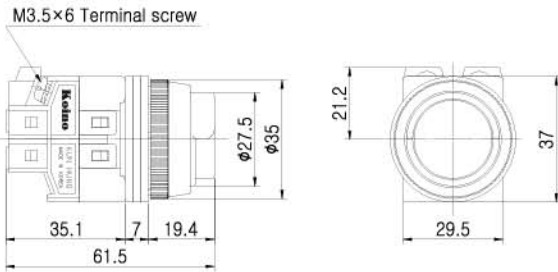

KH-3081

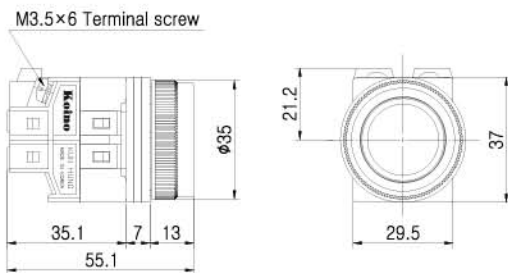

KH-3081EB

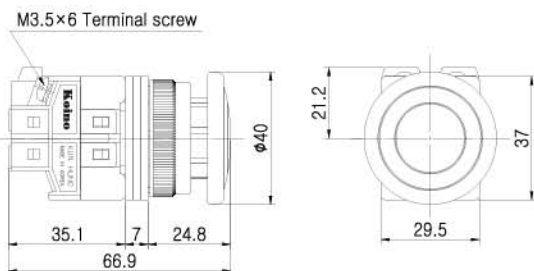

CONTROL COMPONENTS

SQUARE LIGHT

TOWER LIGHT

MICRO SWITCH

FOOT SWITCH

LIMIT SWITCH

POWER SWITCH

HOIST SWITCH

CAM SWITCH

BUZZER

PHOTO SENSOR

PROXIMITY SENSOR

FLOATLESS LEVEL SWITCH

TIMER & COUNTER

RELAY

SOCKETS

TERMINAL BLOCK

CONTROL BOX

PID TEMP. CONTROLLER



KH-3040

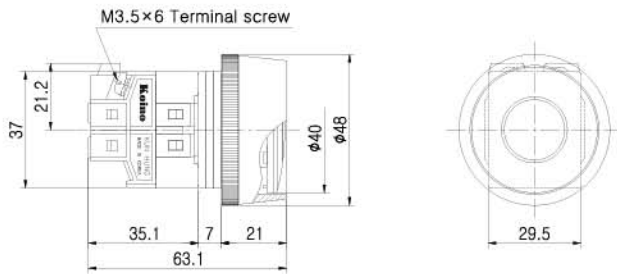

KH-3046ER

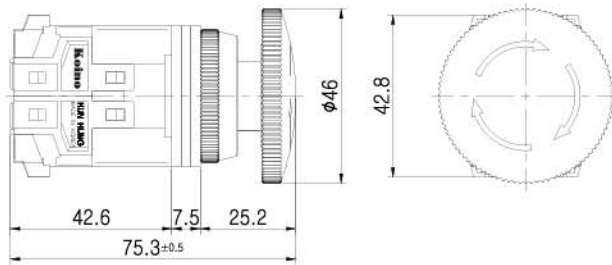

KH-3065EB

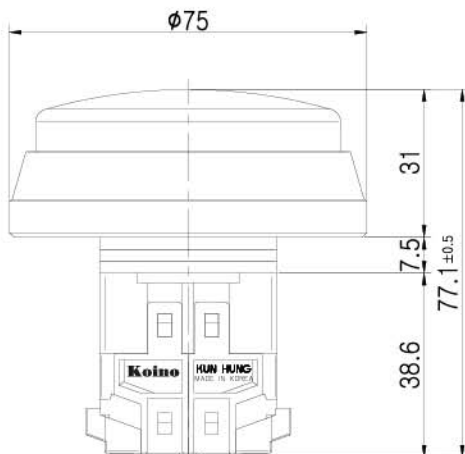

KH-3066EB

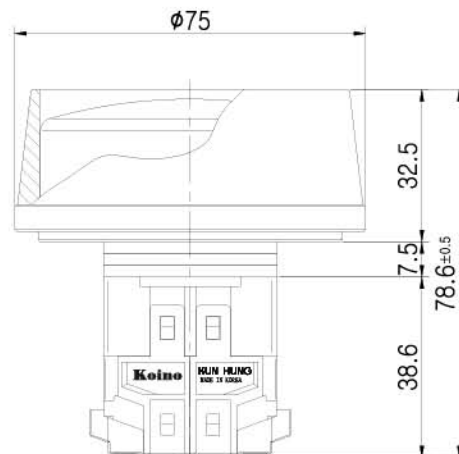



CONTROL COMPONENTS

SQUARE LIGHT

TOWER LIGHT

MICRO SWITCH

FOOT SWITCH

LIMIT SWITCH

POWER SWITCH

HOIST SWITCH

CAM SWITCH

BUZZER

PHOTO SENSOR

PROXIMITY SENSOR

FLOATLESS LEVEL SWITCH

TIMER & COUNTER

RELAY

SOCKETS

TERMINAL BLOCK

CONTROL BOX

PID TEMP. CONTROLLER

Technical Information

Switching System

The switching element of KH-30XX is equipped with normally open contact and normally closed contact.

1A, 1B, 2A, 2B 1A1B, 2A2B 3A1B and 1A3B contacts are available. Normally 4 contact blocks can be assembled

Mechanical Characteristics

Mechanical Lifetime

KH-3008 : 1,000,000 Cycles of operation

KH-3081, -3081EB: 1,000,000 Cycles of operation

KH-3040: 250,000 Cycles of operation

KH-3046ER: 250,000 Cycles of operation

KH-3065EB: 250,000 Cycles of operation

KH-3066EB: 250,000 Cycles of operation

Electrical Characteristics

Standards

This product comply with “ Standards for low-voltage switching devices” EN IEC 60947-5-1

Contact Ratings

125VAC 10A, 250VAC 6A (resistive load)

Insulation Resistance

Minimum 100M Ω (500VDC)

Contact Resistance

Maximum 30m Ω

Electrical Lifetime

100,000 cycles of operation



Electrical Characteristics—continues

Dielectric Strength

Between Live Parts: 1,500VAC(50/60Hz) for 1 minute

Between Live and Dead Parts: 1,500VAC(50/60Hz) for 1 minute

Environmental conditions

Operational Temperature

-25°C~+50°C(NOT FREEZING CONDITION)

Operational Humidity

45~85%RH

Protection Degree

IP40

Shock Resistance

KH-3008, KH-3081, KH-3081EB: Approximately 50G

KH-3040, KH-3046, KH-3065EB, KH-3066EB: Approximately 20G

Vibration Resistance

10~55Hz double amplitude 1.5mm (at X, Y and Z axis)

Approvals

Approbations

CCC

Declaration of Conformity

NONE

ACCESSORIES

Contact Block

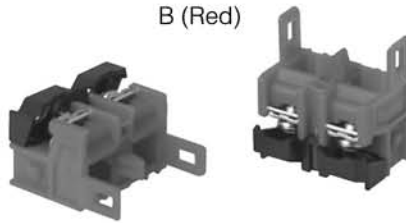
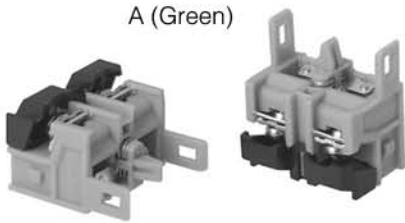

Dummy Block



Contact Block Guard



Anti-rotating Ring



Ø22, Ø25, Ø30

Aluminum Ring



Ø25, Ø30

Safety Cover



KA-005 (Ø25), KA-22(Ø252)
KA-25 (Ø25), KA-30(Ø30)



PC-25(Ø25)
PC-30(Ø30)



SC-022(Ø22)
SC-025(Ø25)
SC-030(Ø30)

CONTROL COMPONENTS

SQUARE LIGHT

TOWER LIGHT

MICRO SWITCH

FOOT SWITCH

LIMIT SWITCH

POWER SWITCH

HOIST SWITCH

CAM SWITCH

BUZZER

PHOTO SENSOR

PROXIMITY SENSOR

FLOATLESS LEVEL SWITCH

TIMER & COUNTER

RELAY

SOCKETS

TERMINAL BLOCK

CONTROL BOX

PID TEMP. CONTROLLER